

3M™ MS²™ Modular Splicing Rigs and Equipment



3M MS² splicing tools and equipment are easy to use in any kind of splicing operation, regardless of the environment or working conditions. By designing system components and techniques that are interchangeable, 3M simplifies the splicing task and reduces potential inventory headaches. Included in the system are detailed step-by-step instructions for each splicing application, user-friendly parts and components, and testing equipment to optimize splice accuracy.

Systemized splicing technology

MS² splicing simplifies wire joining and terminating operations by allowing many jobs to be performed with the same components, tools, and techniques. Any of the standard MS² splicing rigs with MS² splicing modules could meet all of your multi-pair splicing requirements in inside or outside plant — new construction, cable rearrangements or maintenance. Straight forward procedures designed to allow both splicing accuracy and good housekeeping, make the system's components simple to master.

3M™ MS²™ SPLICING RIG ACCESSORIES

PRODUCT NUMBER/ PACKAGING INFO	DESCRIPTION
3M710-TMK10-A PKG. (LBS.): 1 EACH (16.50) MIN. ORDER: 1 EACH UPC: 051138-78481	Support Rig Allows flexibility in mounting applications for pedestals, racks, manholes, etc. Can be used with 3M710 and MS ² .
4025 PKG. (LBS.): 1 EACH (1.91) MIN. ORDER: 1 EACH UPC: 054007-26468	Support Vise Used to mount the 4040 splicing head assembly in tight situations.
4028A PKG.: 1 EACH MIN. ORDER: 1 EACH UPC: 051138-70971	Tool Box with Modified Tray Durable, easy to transport tool box with tray 66 x 29.2 x 28.2 cm (26 x 11.5 x 11.1) Cube: 9.8 kg. (21.7 lbs.) Ctn. size: 67.1 x 30 x 58.4 cm (26.4 x 11.8 x 23").
4030 PKG. (LBS.): 1 EACH (18.20) MIN. ORDER: 1 EACH UPC: 054007-30183	Air/Hydraulic Crimping Unit Designed for high-volume module termination and uses air or nitrogen supply. An air cylinder or compressor with output pressure of 5.37 kg/cm 21 (90-100 PSI) must be used. The unit is either hand- or foot-operated.
4031 PKG. (LBS.): 1 EACH (13.75) MIN. ORDER: 1 EACH UPC: 054007-30184	Hand/Hydraulic Crimping Unit Lightweight and hand-operated. When proper crimping pressure is reached, a bypass valve opens.
4035A PKG. (LBS.): 1 EACH (3.65) MIN. ORDER: 1 EACH UPC: 054007-31917	Strand Clamp Designed to hold a 4041-P splicing head in aerial splicing applications. Anchored to the suspension strand, the strand clamps behind and below the splice bundle and can be used with strands from 5 mm (3/16") diameter to 10 mm (3/8").
4036-25 PKG. (LBS.): 1 EACH (9.00) MIN. ORDER: 1 EACH UPC: 054007-92843	Hand Crimper A self-contained, pistol-gripped crimper designed to crimp MS ² modules in the 4041 splicing head.
4039 PKG. (LBS.): 144 EACH (3.50) MIN. ORDER: 144 EACH UPC: 054007-57516	Marking Pen Use the 4039 marking pen for permanent marking for MS ² modules for easy identification at a later date.
4040 PKG. (LBS.): 1 EACH (6.50) MIN. ORDER: 1 EACH UPC: 054007-27822	Splicing Head Assembly Contains a splicing head, a pedestal, a traverse clamp assembly with a long bar, and a head clamp for use with two-man fold-back splicing.
4041-SH PKG. (LBS.): 1 EACH (7.00) MIN. ORDER: 1 EACH UPC: 054007-92955	Splicing Head Holder For use with MS ² splicing head.



3M™ MS²™ SPLICING RIG ACCESSORIES

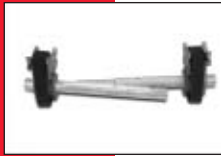
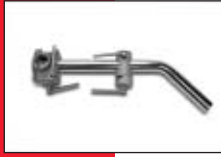

PRODUCT NUMBER/ PACKAGING INFO	DESCRIPTION
4041SPL PKG. (LBS.): 1 EACH (2.80) MIN. ORDER: 1 EACH UPC: 054007-27823	Splicing Head The standard MS ² splicing head without any support components.
4041-P PKG. (LBS.): 1 EACH (3.69) MIN. ORDER: 1 EACH UPC: 054007-30266	Splicing Head with "T" Bar Pedestal MS ² splicing head and "T" Bar support for use with the MS ² system.
4045-SHSA PKG. (LBS.): 1 EACH (6.50) MIN. ORDER: 1 EACH UPC: 054007-30219	Universal Splicing Head Support Assembly Designed to hold an MS ² splicing head so it can be used in all applications.
4046-CST PKG. (LBS.): 1 EACH (7.00) MIN. ORDER: 1 EACH UPC: 054007-17626	Collapsible Support Tube Collapsible for easy transport and set up.
4047 PKG. (LBS.): 10 EACH (2.29) MIN. ORDER: 10 EACH UPC: 054007-30220	Pair Test Plug A module probe which permits one-pair checking without damaging wire insulation. The prongs fit the test entry port of all MS ² modules. The cord permits easy connection to a talk block or test set.
4051 PKG. (LBS.): 10 EACH (1.55) MIN. ORDER: 10 EACH UPC: 054007-31137	Wire Insertion and Cut-off Tool Used to terminate individual conductors on MS ² modules.
4052T PKG. (LBS.): 10 EACH (1.40) MIN. ORDER: 10 EACH UPC: 054007-33796	Check Comb Minimizes the risk of wiring errors by double-checking tip and ring placement prior to crimping.
4053 PKG. (LBS.): 10 EACH (1.40) MIN. ORDER: 10 EACH UPC: 054007-30185	Cover Removal Tool Recommended for removing either bases or covers from 25-pair 3M™ MS ² ™ super-mini and super-mate modules.
4053-PM PKG. (LBS.): 1 EACH (1.30) MIN. ORDER: 1 EACH UPC: 054007-34404	Separation Tool The only recommended tool to separate 4005-DPM/TR modules from any other module. Note: The 4053 cover removal tool cannot be used to separate DPM modules.
4270-A PKG. (LBS.): 1 EACH (2.90) MIN. ORDER: 1 EACH UPC: 054007-71280	Hand Presser Used to plug up to seven super-mate modules together.

3M™ MS²™ SPLICING RIG SPARE PARTS

MS² SPLICING HEAD 4041P

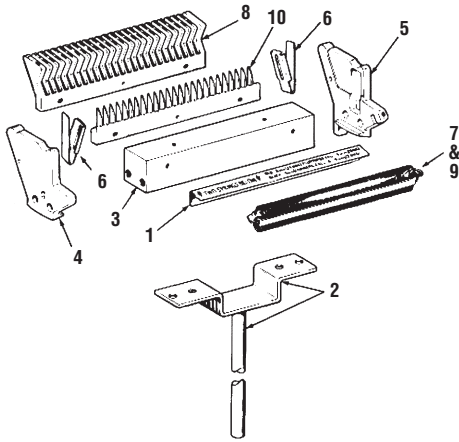

#	PRODUCT NUMBER	DESCRIPTION	PKG. (LBS.)	MIN. ORDER	UPC 054007-
1	Spare-Rigs/HTP	Head tape plate	1 each (1.00)	1 each	26479
2	Spare-Rigs/PED	Pedestal	1 each (1.00)	1 each	26478
3	Spare-Rigs/SHB	Splice head body	1 each (1.00)	1 each	26289
4	Spare-Rigs/SHLP	Splice head side plate - left hand	1 each (1.00)	1 each	26860
5	Spare-Rigs/SHRP	Splice head side plate - right hand	1 each (1.00)	1 each	26861
6	Spare-Rigs/SHLS	Splicing head leaf spring universal	1 each (1.00)	1 each	75718*
7	Spare-Rigs/SWR	Spring wire retainer 20-24, 26-28 gauge (blue/brown)	1 each (0.25)	1 each	26476
8	Spare-Rigs/WGK	Wire guide kit	1 each (0.25)	1 each	17636
9	Spare-Rigs/WRA 2226	Spring wire retainer assy. 22-26 gauge (red/black)	1 each (1.00)	1 each	26480
10	Spare-Rigs/WSK kit	Wire separator	1 each (1.00)	1 each	26481

*UPC prefix 051138-

MS² UNIVERSAL SPLICING HEAD SUPPORT ASSEMBLY 4045

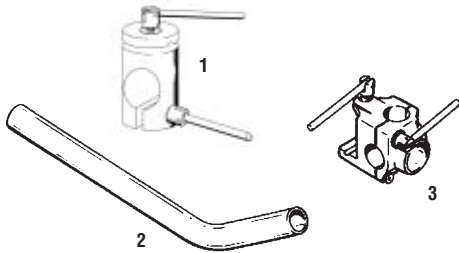

#	PRODUCT NUMBER	DESCRIPTION	PKG. (LBS.)	MIN. ORDER	UPC 054007-
1	4045-HCA	Universal head clamp assembly	1 each (1.50)	1 each	26332
2	4045-ST	Universal support tube	1 each (1.00)	1 each	26333
3	4045-VA	Vise final assembly	1 each (3.00)	1 each	26331

ACCESSORIES

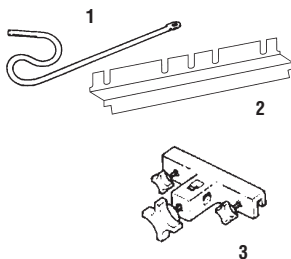

#	PRODUCT NUMBER	DESCRIPTION	PKG. (LBS.)	MIN. ORDER	UPC 054007-
1	4041-2	.05 m (2") Unilength hook	1 each (2.55)	1 each	63857
2	4041-RS	Rear spring holder	1 each	1 each	68203
3	4025	Support vise	1 each (1.91)	1 each	26468

SPARE PARTS

3M™ MS™ SPLICING RIG

#	PRODUCT NUMBER	DESCRIPTION	PKG. (LBS.)	MIN. ORDER	UPC 054007-
1	Spare-Rigs/24CS	60.9 cm (24") cable strap	1 each (1.00)	1 each	26287
2	Spare-Rigs/CA	Clamp assembly	1 each (1.00)	1 each	18248*
3	Spare-Rigs/HKCA	Hand knob clamp assembly	1 each (1.00)	1 each	26284
4	Spare-Rigs/PS	Splicing pedestal stand	1 each (21.00)	1 each	63854
5	Spare-Rigs/STB	Short traverse bar	1 each (1.00)	1 each	26288
6	Spare-Rigs/STS	Support tube stand (two per set)	1 each (21.00)	1 each	63852
7	Spare-Rigs/TSXA	Tube support extension assembly	1 each (1.00)	1 each	26330
8	4046-STNC	Collapsible support tube without clamps	1 each (3.00)	1 each	92825
9	Spare-Rigs/TC	Traverse clamp assembly	1 each (1.00)	1 each	26283
10	Spare-Rigs/LTB	Long traverse bar	1 each (1.10)	1 each	26285
11	4049-0 (not pictured)	Organizer w/ bucket and lid (no tools)	1 each (6.00)	1 each	92718
12	4049-NC (not pictured)	Lite rig w/o crimper	1 each (15.00)	1 each	92956
13	4041-SH	Splicing head holder for 4049 rig	1 each (7.00)	1 each	92955
14	4049-VTB	Variable traverse brace	1 each (1.00)	1 each	26467
15	4036-H (not pictured)	Tool holster	1 each (1.08)	1 each	92717

*UPC prefix 051115-

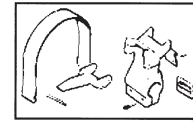

(Assembly) 2

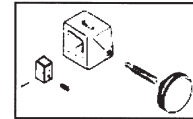

(Assembly) 3

